

Weed Science Field Day—2021

LEXINGTON, KENTUCKY



University of Kentucky
College of Agriculture,
Food and Environment
Cooperative Extension Service

TABLE OF CONTENTS

LIST OF CHEMICALS USED.....	3
DEFINITIONS.....	6
WEATHER DATA	7

CORN

21-23.....	10
21-32.....	12
21-36.....	16
CE2.....	19

SOYBEAN TRIALS

21-19.....	8
21-20.....	9
21-24.....	11
21-33.....	13
21-34.....	14
21-35.....	15
21-37.....	17
21-38.....	18

PESTICIDES USED

<u>TRADE NAME</u>	<u>COMMON NAME</u>	<u>COMPANY</u>
A23372	ATRAZINE	SYNGENTA
AATREX	S-METOLACHLOR + ATRAZINE + MESOTRIONE + BICYCLOPYRONE	SYNGENTA
ACURON	S-METOLACHLOR + ATRAZINE + MESOTRIONE + BICYCLOPYRONE + GLYPHOSATE	SYNGENTA
ACURON GT	S-METOLACHLOR + ATRAZINE + MESOTRIONE + BICYCLOPYRONE	SYNGENTA
ACURON XR	NON-IONIC SURFACTANT	LOVELAND
ACTIVATOR 90	AMMONIUM SULFATE	CLEAN CROP
AMS	AMMONIUM SULFATE	WINFIELD
AMSOL	ATRAZINE + FLUTHIACET-METHYL + PYROXASULFONE	FMC
ANTHEM ATZ	PYROXASULFONE + FLUTHIACET-METHYL	FMC
ANTHEM MAXX	DIMETHENAMID-P + TOPRAMEZONE	BASF
ARMEZON PRO	QUIZALOFOP P-ETHYL	AMVAC
ASSURE II		VARIOUS
ATRAZINE		FMC
AUTHORITY FIRST	SULFENTRAZONE + CLORANSULAM-METHYL	FMC
AUTHORITY MTZ	METRIBUZIN + SULFENTRAZONE	FMC
AUTHORITY XL	SULFENTRAZONE + CHLORIMURON-ETHYL	FMC
BCS-720	3 WAY MIX	BAYER
BICEP II MAGNUM	ATRAZINE + S-METOLACHLOR	SYNGENTA
BOUNDARY	S-METOLACHLOR + METRIBUZIN	SYNGENTA
BROADAXE XC	SULFENTRAZONE + S-METOLACHLOR	SYNGENTA
CANOPY	METRIBUZIN + CHLORIMURON ETHYL	CORTEVA
CAPRENO	THIENCARBOZONE + TEMBOTRIONE	BAYER
CLASS ACT RIDION	WATER CONDITIONER + SURFACTANT	WINFIELD
CLASSIC	CHLORIMUORN	DUPONT
CORVUS	ISOXAFLUTOLE + THIENCARBAZONE-METHYL	BAYER
CROP OIL CONCENTRATE (COC)		LOVELAND
DELTAFORCE	DRA	LOVELAND
DELTA LOCK	PH BUFFER	LOVELAND
DIMETRIC LIQUID	METRIBUZIN	LOVELAND
DRIFT X	DEPOSITOIN AND DRIFT MANAGEMENT	WINFIELD
DUAL II MAGNUM	S-METOLACHLOR	COSTAL AGROBUSINESS
ENGENIA	DICAMBA	SYNGENTA
ENLIST DUO	2,4-D(CHOLINE) + GLYPHOSATE	BASF
ENLIST ONE	2,4-D(CHOLINE)	CORTEVA

PESTICIDES USED (CONTINUED)

<u>TRADE NAME</u>	<u>COMMON NAME</u>	<u>COMPANY</u>
EVERPREX	S-METOLACHLOR	CORTEVA
FERCE EZ	FLUMIOXAZIN + PYROXASULFONE	VALENT
FERCE MTZ	FLUMIOXAZIN + PYROXASULFONE + METRIBUZIN	VALENT
FIRSTRATE	CLORNUSULAM-METHYL	CORTEVA
GLORY	METRIBUZIN	AMVAC
GRAMOXONE	PARAQUAT	SYNGENTA
HARNES XTRA	ACETOCHLOR + ATRAZINE	BAYER
HARNES MAX	ACETOCHLOR + MESOTRIONE	BAYER
INDUCE	NONIONIC SURFACTANT	HELENA
INTACT	DRIFT CONTROL + DEPOSITION AID	PRECISION LABS
INTERLINE	GLUFOSINATE	UPI
KYBER	FLUMIOXAZIN + PYROXASULFONE + METRIBUZIN	CORTEVA
LAUDIS	TEMBOTRIONE	BAYER
LIBERTY 280	GLUFOSINATE AMMONIUM	BASF
MAULER	METRIBUZIN	VALENT
MOCCASIN MTZ	METRIBUZIN + S-METOLACHLOR	UPI
MON 301668	ENCAPSULATED ACETOCHLOR	BAYER
MON 51817		BAYER
MSO	METHYLATED SEED OIL	LOVELAND
NIS	NON-IONIC SURFACTANT	VARIOUS
NPAK AMS LIQUID	AMMONIUM SULFATE	WINFIELD
PERPETUO	FLUMICLORAC + PYROXASULFURON	VALENT
PREFIX	S-METOLACHLOR + BENOXACOR	SYNGENTA
PYTHON	FLUMETSULAM	AMVAC
REFLEX	FOMESAFEN	SYNGENTA
RESICORE	ACETOCHLOR + CLOPYRALID + MESOTRIONE	CORTEVA
REVULIN Q	NICOSULFURON + MESOTRIONE	CORTEVA
ROUNDUP POWERMAX	GLYPHOSATE (POTASSIUM SALT)	BAYER
ROUNDUP POWERMAX 3	GLYPHOSATE (POTASSIUM SALT)	BAYER
ROUNDUP WEATHERMAX	GLYPHOSATE (POTASSIUM SALT)	BAYER

PESTICIDES USED (CONTINUED)

<u>TRADE NAME</u>	<u>COMMON NAME</u>	<u>COMPANY</u>
SCEPTER	IMAZIQUIN	AMVAC
SCOUT	GLUFOSINATE	VALENT
SELECT MAX	CLETHODIM	VALENT
SENCOR	METRIBUZIN	BAYER
SUPERB HC	CROP OIL CONCENTRATE	AGRSOLUTIONS
SURESTART II	ACETOCHLOR + CLOPYRALID + FLUMETSULAM	CORTEVA
TAVIUM PLUS VAPORGRIP	S-METOLACHLOR + DICAMBA	SYNGENTA
TRIPZIN	PENDIMETHALIN + METRIBUZIN	UPI
TRIVENCE	CHLORIMURON + FLUMIOXAZIN + METRIBUZIN	DUPONT
V-10494	FLUMIOXAZIN	VALENT
VALOR EZ	FLUMIOXAZIN + CHLORIMURON	VALENT
VALOR XLT	DIMETHENAMID-P + SAFLUFENACIL	VALENT
VERDICT	PH BUFFER	BASF
VOLT EDGE	ACETOCHLOR + FOMESAFEN	WINFIELD
WARRANT ULTRA	DICAMBA + VAPROGRIP TECHNOLOGY	BAYER
XTENDIMAX WITH VAPORGRIP	PYROXASULFONE + SAFLUFENACIL + IMAZETHAPYR	BAYER
ZIDUA PRO		BASF

APPLICATION TIMING

PREEMERGENCE

BURNDOWN	BURNDOWN EXISTING VEGETATION
PRE, PREEM	PREEMERGENCE

POSTEMERGENCE

POSPOS	2-3" WEEDS
POST	3-4 " WEEDS, 1-2 TILLERS
2"W	2" WEEDS
4"W	4" WEEDS
V2	SECOND TRIFOLIATE (SOYBEAN), 2 COLLAR CORN
42DAP	42 DAYS AFTER PLANTING

Spindletop Climate Data, April 2021

This weather data provided by the University of Kentucky
 Agricultural Weather Center (Phone (859)257-3000 Ext245)
 World Wide Web URL: <http://www.wagwx.ca.uky.edu/>

DATE	AIR TEMP			PRECIP	RH		SOIL TEMP				EVAP
	MX	MN	AV		MX	MN	GRASS	BARE	MX	MN	
04-01-2021	40	29	34		69	47	51	49			
04-02-2021	45	24	34		84	34	55	47			
04-03-2021	60	27	43		80	23	58	57			
04-04-2021	69	46	57		51	32	52	47			
04-05-2021	72	44	58		80	34	54	49			
04-06-2021	75	47	61		82	40	56	51			
04-07-2021	79	54	66		83	44	58	53			
04-08-2021	67	59	63	0.17	97	59	57	56			
04-09-2021	77	50	63		92	30	58	55			
04-10-2021	66	57	61	0.70	99	47	58	56			
04-11-2021	57	49	53	0.01	91	63	57	55			
04-12-2021	67	45	56		98	42	57	54			
04-13-2021	65	50	57	0.02	82	51	57	54			
04-14-2021	58	45	51	0.40	95	58	57	55			
04-15-2021	53	39	46		94	51	55	53			
04-16-2021	58	35	46		92	47	65	55			
04-17-2021	59	42	50		94	52	55	51			
04-18-2021	62	39	50		100	41	54	51			
04-19-2021	65	44	54		93	40	55	52			
04-20-2021	68	43	55		83	36	55	53			
04-21-2021	44	32	38	0.15	100	52	55	51			
04-22-2021	52	31	41		92	35	52	49			
04-23-2021	59	32	45		88	42	51	48			
04-24-2021	52	47	49	0.71	99	58	52	50			
04-25-2021	59	45	52		100	58	53	51			
04-26-2021	73	40	56		100	34	55	51			
04-27-2021	79	57	68		79	40	58	54			
04-28-2021	78	64	71	0.05	99	55	60	57			
04-29-2021	68	55	61	0.51	100	79	60	59			
04-30-2021	71	49	60		100	30	60	58			

Summary for the period 4-1-2021 through 4-30-2021:

	AIR TEMP			TOTAL PRECIP	RH		SOIL TEMP				TOTAL EVAP
	MX	MN	AV		MX	MN	GRASS	BARE	MX	MN	
	63	44	54	2.72	90	45	56	53			
(Deviation from normal)	-2	-1	-2	-1.16							

Spindletop Climate Data, May 2021

This weather data provided by the University of Kentucky
 Agricultural Weather Center (Phone (859)257-3000 Ext245)
 World Wide Web URL: <http://www.wagwx.ca.uky.edu/>

DATE	AIR TEMP			PRECIP	RH		SOIL TEMP				EVAP
	MX	MN	AV		MX	MN	GRASS MX	GRASS MN	BARE MX	BARE MN	
05-01-2021	69	39	54		71	34	60	56			
05-02-2021	74	52	63	0.03	91	38	59	57			
05-03-2021	73	58	65	0.57	100	73	61	59			
05-04-2021	76	61	68	1.24	99	65	63	60			
05-05-2021	63	48	55	0.39	100	50	63	61			
05-06-2021	63	41	52		89	45	61	57			
05-07-2021	63	43	53	0.05	93	40	60	58			
05-08-2021	61	41	51		91	38	60	58			
05-09-2021	68	45	56	0.28	93	50	60	59			
05-10-2021	60	42	51		90	44	61	58			
05-11-2021	62	42	52		87	45	61	58			
05-12-2021	62	46	54		61	37	61	58			
05-13-2021	64	45	54		66	29	61	58			
05-14-2021	68	46	57		61	23	61	57			
05-15-2021	71	44	57		78	30	61	57			
05-16-2021	66	54	60	0.05	93	50	61	60			
05-17-2021	72	58	65		90	65	62	60			
05-18-2021	77	61	69	0.02	96	52	64	62			
05-19-2021	81	58	69		96	46	65	62			
05-20-2021	82	60	71		91	44	66	63			
05-21-2021	83	60	71		86	39	67	63			
05-22-2021	85	61	73		90	37	67	64			
05-23-2021	84	63	73		86	40	67	65			
05-24-2021	87	66	76		81	39	68	65			
05-25-2021	88	63	75		93	38	68	66			
05-26-2021	83	66	74	0.48	100	50	68	67			
05-27-2021	81	65	73		100	41	69	67			
05-28-2021	75	54	64	1.22	99	71	69	68			
05-29-2021	54	47	50	0.01	98	80	68	63			
05-30-2021	62	47	54		92	60	63	62			
05-31-2021	73	46	59		100	46	64	61			

Summary for the period 5-1-2021 through 5-31-2021:

	AIR TEMP			TOTAL PRECIP	RH		SOIL TEMP				TOTAL EVAP
	MX	MN	AV		MX	MN	GRASS MX	GRASS MN	BARE MX	BARE MN	
	72	52	62	4.34	89	46	64	61			
(Deviation from normal)	-4	-3	-3	-0.13							

Spindletop Climate Data, June 2021

This weather data provided by the University of Kentucky
 Agricultural Weather Center (Phone (859)257-3000 Ext245)
 World Wide Web URL: <http://www.agwx.ca.uky.edu/>

DATE	AIR TEMP			PRECIP	RH		SOIL TEMP		EVAP
	MX	MN	AV		MX	MN	GRASS	BARE	
06-01-2021	73	56	64	0.01	95	56	64	63	
06-02-2021	68	62	65	0.22	99	85	65	64	
06-03-2021	73	61	67	0.90	99	73	65	64	
06-04-2021	82	60	71		100	42	68	65	
06-05-2021	84	59	71		99	45	69	66	
06-06-2021	80	65	72	0.05	97	68	69	68	
06-07-2021	78	70	74	0.12	99	76	70	69	
06-08-2021	84	68	76	1.41	100	62	71	69	
06-09-2021	78	69	73	0.39	100	79	71	70	
06-10-2021	82	68	75	0.03	100	72	72	70	
06-11-2021	84	68	76	0.79	100	65	73	71	
06-12-2021	87	66	76	0.19	100	55	74	71	
06-13-2021	87	67	77	0.08	98	60	75	72	
06-14-2021	87	65	76		97	43	76	72	
06-15-2021	79	59	69		85	44	74	72	
06-16-2021	78	60	69		86	38	74	71	
06-17-2021	82	58	70		91	40	73	70	
06-18-2021	87	63	75		88	57	74	71	
06-19-2021	84	66	75	0.10	98	58	74	72	
06-20-2021	86	68	77		92	58	76	72	

Summary for the period 6-1-2021 through 6-30-2021:

	AIR TEMP			TOTAL PRECIP	RH		SOIL TEMP		TOTAL EVAP
	MX	MN	AV		MX	MN	GRASS	BARE	
	81	64	73	4.29	96	59	71	69	
(Deviation from normal)	-1	+3	+1	+1.85					

University of Kentucky

Evaluate efficacy of AMVAC soybean herbicides when used in a soybean herbicide program

Trial ID: 21C12H114 Location: Trial Year: 2021
 Protocol ID: 21C12H114 Investigator (Creator): Sara Carter
 Project ID: Study Director:
 Sponsor Contact:

PLANTED: 5/13/21 AG 35XF1 150,000 S/A

PRE: 5/14/21

Trt No.	Type	Treatment Name	Form Conc	Form Unit	Form Type	Rate	Rate Unit	Appl Timing	Appl Code	Rep 1	Rep 2	Rep 3	Rep 4	Notes
1	CHK	NTC								101	205	303	401	
2	HERB	Dual II Magnum	7.64	LBA/GAL	EC	20	FL OZ/A	PREEM A		102	201	305	405	
3	HERB	Dual II Magnum HERB FirstRate	7.64 84 %	LBA/GAL	EC WG	20 0.5	FL OZ/A OZ/A	PREEM A PREEM A		103	202	304	402	
4	HERB	Dual II Magnum HERB Scepter	7.64 70 %	LBA/GAL	EC WG	20 2.8	FL OZ/A OZ/A	PREEM A PREEM A		104	206	302	406	
5	HERB	Dual II Magnum HERB Python	7.64 80 %	LBA/GAL	EC WG	20 1.0	FL OZ/A OZ/A	PREEM A PREEM A		105	203	306	404	
6	HERB	Dual II Magnum HERB FirstRate HERB Glory	7.64 84 % 75 %	LBA/GAL	EC WG DF	20 0.5 0.5	FL OZ/A OZ/A LB/A	PREEM A PREEM A PREEM A		106	204	301	403	

Sort Order: Replicate 1

University of Kentucky

Trial ID: 21C13H115 Location: Trial Year: 2021
 Protocol ID: 21C13H115 Investigator (Creator): Sara Carter
 Project ID: Study Director:
 Sponsor Contact:

PLANTED 5/13/21 AG 35XF1 150000 S/A

PRE: 5/14/21 POST: 6/10/21

Trt No.	Treatment Name	Form Conc	Form Unit	Form Type	Rate Rate	Rate Unit	Appl Timing	Appl Code	Rep 1	Rep 2	Rep 3	Rep 4	Notes
1	CHK NTC								101	203	304	405	
2	HERB Dual II Magnum	7.64	LBA/GAL	EC	16	FL OZ/A	PREPRE	A	102	205	301	409	
	HERB Liberty	2.34	LBA/GAL	SL	32	FL OZ/A	POSPOS	B					
	HERB Dual II Magnum	7.64	LBA/GAL	EC	16	FL OZ/A	POSPOS	B					
	ADJ Ammonium Sulfate	100 %		SG	3	LB/A	POSPOS	B					
3	HERB Dual II Magnum	7.64	LBA/GAL	EC	16	FL OZ/A	PREPRE	A	103	204	307	401	
	HERB Liberty	2.34	LBA/GAL	SL	32	FL OZ/A	POSPOS	B					
	HERB Classic	25 %	AW/W	DF	0.5	OZ WT/A	POSPOS	B					
	HERB Dual II Magnum	7.64	LBA/GAL	EC	16	FL OZ/A	POSPOS	B					
	ADJ Ammonium Sulfate	100 %		SG	3	LB/A	POSPOS	B					
4	HERB Dual II Magnum	7.64	LBA/GAL	EC	16	FL OZ/A	PREPRE	A	104	208	303	408	
	HERB Liberty	2.34	LBA/GAL	SL	32	FL OZ/A	POSPOS	B					
	HERB FirstRate	84 %		WG	0.4	OZ WT/A	POSPOS	B					
	HERB Dual II Magnum	7.64	LBA/GAL	EC	16	FL OZ/A	POSPOS	B					
	ADJ Ammonium Sulfate	100 %		SG	3	LB/A	POSPOS	B					
5	HERB Dual II Magnum	7.64	LBA/GAL	EC	16	FL OZ/A	PREPRE	A	105	201	308	404	
	HERB Engenia	5	LBA/GAL	SL	12.8	FL OZ/A	POSPOS	B					
	HERB Roundup Powermax	5.5	LBA/GAL	SL	32	FL OZ/A	POSPOS	B					
	HERB Dual II Magnum	7.64	LBA/GAL	EC	16	FL OZ/A	POSPOS	B					
	ADJ DeltaForce			L	0.5 %	V/V	POSPOS	B					
	ADJ DeltaLock				20	FL OZ/A	POSPOS	B					
6	HERB Dual II Magnum	7.64	LBA/GAL	EC	16	FL OZ/A	PREPRE	A	106	207	309	407	
	HERB Engenia	5	LBA/GAL	SL	12.8	FL OZ/A	POSPOS	B					
	HERB FirstRate	84 %		WG	0.4	OZ WT/A	POSPOS	B					
	HERB Roundup Powermax	5.5	LBA/GAL	SL	32	FL OZ/A	POSPOS	B					
	HERB Dual II Magnum	7.64	LBA/GAL	EC	16	FL OZ/A	POSPOS	B					
	ADJ DeltaForce			L	0.5 %	V/V	POSPOS	B					
	ADJ DeltaLock				20	FL OZ/A	POSPOS	B					
7	HERB Dual II Magnum	7.64	LBA/GAL	EC	16	FL OZ/A	PREPRE	A	107	206	302	410	
	HERB Engenia	5	LBA/GAL	SL	12.8	FL OZ/A	POSPOS	B					
	HERB Classic	25 %	AW/W	DF	0.5	OZ WT/A	POSPOS	B					
	HERB Roundup Powermax	5.5	LBA/GAL	SL	32	FL OZ/A	POSPOS	B					
	HERB Dual II Magnum	7.64	LBA/GAL	EC	16	FL OZ/A	POSPOS	B					
	ADJ DeltaForce			L	0.5 %	V/V	POSPOS	B					
	ADJ DeltaLock				20	FL OZ/A	POSPOS	B					
8	HERB Dual II Magnum	7.64	LBA/GAL	EC	16	FL OZ/A	PREPRE	A	108	202	305	402	
	HERB Engenia	5	LBA/GAL	SL	12.8	FL OZ/A	POSPOS	B					
	HERB Python	80 %		WG	0.125	OZ WT/A	POSPOS	B					
	HERB Roundup Powermax	5.5	LBA/GAL	SL	32	FL OZ/A	POSPOS	B					
	HERB Dual II Magnum	7.64	LBA/GAL	EC	16	FL OZ/A	POSPOS	B					
	ADJ DeltaForce			L	0.5 %	V/V	POSPOS	B					
	ADJ DeltaLock				20	FL OZ/A	POSPOS	B					
9	HERB Dual II Magnum	7.64	LBA/GAL	EC	16	FL OZ/A	PREPRE	A	109	210	306	403	
	HERB Classic	25 %	AW/W	DF	0.5	OZ WT/A	POSPOS	B					
	HERB Assure II	0.88	LBA/GAL	EC	12	FL OZ/A	POSPOS	B					
	HERB Reflex	2	LBA/GAL	EC	16	FL OZ/A	POSPOS	B					
	ADJ Ammonium Sulfate	100 %		SG	2	LB/A	POSPOS	B					
	ADJ COC	100 %		SL	1 %	V/V	POSPOS	B					
10	HERB Dual II Magnum	7.64	LBA/GAL	EC	16	FL OZ/A	PREPRE	A	110	209	310	406	
	HERB FirstRate	84 %		WG	0.4	OZ WT/A	POSPOS	B					
	HERB Assure II	0.88	LBA/GAL	EC	12	FL OZ/A	POSPOS	B					
	HERB Reflex	2	LBA/GAL	EC	16	FL OZ/A	POSPOS	B					
	ADJ Ammonium Sulfate	100 %		SG	2	LB/A	POSPOS	B					
	ADJ COC	100 %		SL	1 %	V/V	POSPOS	B					

Sort Order: Replicate 1

University of Kentucky

BCS-720/CORN/PRE

Trial ID: 21-23 Location: LEXINGTON, KY Trial Year: 2021
 Protocol ID: HN21USAEOA Investigator (Creator): Sara Carter
 Project ID: Study Director:
 Sponsor Contact:

PLANTED 5/13/21 DKC 65-95 32000 S/A
 PRE: 5/15/21

Trt No.	Treatment Type Name	Form Conc	Form Unit	Form Type	Form Rate	Rate Unit	Other Rate	Other Rate Unit	Appl Timing	Appl Code	Rep 1	Rep 2	Rep 3	Rep 4	Notes
1	HERB UNTREATED										101	208	303	408	
2	HERB BCS-720 HERB ATRAZINE	489.8 g/L 4		SC L	537 g Al/ha 9.4 g Al/ha		15 OZ/A 1 QT/A		PRE PRE	A A	102	205	309	406	
3	HERB CORVUS HERB ATRAZINE	2.63 4		SC L	152.9 g Al/ha 9.4 g Al/ha		4.5 OZ/A 1 QT/A		PRE PRE	A A	103	202	311	401	
4	HERB ACURON	3.44		ZC	18.1 g Al/ha		2.25 QT/A		PRE	A	104	212	308	402	
5	HERB RESICORE HERB ATRAZINE	3.3 4		SC L	17.4 g Al/ha 9.4 g Al/ha		2.25 QT/A 1 QT/A		PRE PRE	A A	105	204	301	403	
6	HERB ANTHEM ATZ	4.5		SE	8.9 g Al/ha		1.7 PT/A		PRE	A	106	201	310	409	
7	HERB BCS-720 HERB ATRAZINE	489.8 g/L 4		SC L	610 g Al/ha 9.4 g Al/ha		17 OZ/A 1 QT/A		PRE PRE	A A	107	206	312	405	
8	HERB BCS-720 HERB ATRAZINE	489.8 g/L 4		SC L	670 g Al/ha 9.4 g Al/ha		18.75 OZ/A 1 QT/A		PRE PRE	A A	108	210	306	404	
9	HERB CORVUS HERB ATRAZINE	2.63 4		SC L	1.08 g Al/ha 9.4 g Al/ha		5.6 OZ/A 1 QT/A		PRE PRE	A A	109	211	304	411	
10	HERB ACURON	3.44		ZC	24.1 g Al/ha		3 QT/A		PRE	A	110	207	305	407	
11	HERB RESICORE HERB ATRAZINE	3.3 4		SC L	23.2 g Al/ha 9.4 g Al/ha		3 QT/A 1 QT/A		PRE PRE	A A	111	203	302	410	
12	HERB ANTHEM ATZ	4.5		SE	13.2 g Al/ha		2.5 PT/A		PRE	A	112	209	307	412	

Sort Order: Replicate 1

University of Kentucky

DIC PAIRED SOIL RESIDUAL

Trial ID: 21-24 Location: LEXINGTON, KY Trial Year: 2021
 Protocol ID: HN21USADHA Investigator (Creator): Sara Carter
 Project ID: Study Director:
 Sponsor Contact:

PLANTED 5/13/21 AG 35XF1 150000 S/A

PRE: 5/14/21

Trt No.	Type	Treatment Name	Form Conc	Form Unit	Form Type	Rate Rate Unit	Other Rate	Other Rate Unit	Appl Timing	Appl Code	Rep 1	Rep 2	Rep 3	Rep 4	Notes
1	CHK	Untreated Check									101	202	306	410	
2	HERB	MON 301668	553		CS	2200 mL-g/ha	30 OZ/A		PRE	A	102	204	303	409	
3	HERB	MAULER	480		SL		8 OZ/A		PRE	A	103	201	305	407	
4	HERB	WARRANT ULTRA	3.49	LBA/GAL	CS		50 OZ/A		PRE	A	104	212	308	412	
5	HERB	FIERCE EZ	3.04	LBA/GAL	SC		6 OZ/A		PRE	A	105	207	312	405	
6	HERB	VALOR EZ	4	LB/GAL	SC		2 OZ/A		PRE	A	106	205	304	403	
7	HERB	AUTHORITY MTZ	45		DF		10 OZ/A		PRE	A	107	213	311	404	
8	HERB	MON 301668	553		CS		30 OZ/A		PRE	A	108	203	309	413	
		HERB MAULER	480		SL		8 OZ/A		PRE	A					
		HERB XTENDIMAX	2.9		SL		22 OZ/A		PRE	A					
		HERB MON 51817	394		SL		20 OZ/A		PRE	A					
9	HERB	MON 301668	553		CS		30 OZ/A		PRE	A	109	206	313	402	
		HERB XTENDIMAX	2.9		SL		22 OZ/A		PRE	A					
		HERB MON 51817	394		SL		20 OZ/A		PRE	A					
10	HERB	WARRANT ULTRA	3.49	LBA/GAL	CS		50 OZ/A		PRE	A	110	211	307	401	
		HERB INTACT			L		0.5 % V/V		PRE	A					
		HERB XTENDIMAX	2.9		SL		22 OZ/A		PRE	A					
		HERB MON 51817	394		SL		20 OZ/A		PRE	A					
11	HERB	FIERCE EZ	3.04	LBA/GAL	SC		6 OZ/A		PRE	A	111	209	310	408	
		HERB XTENDIMAX	2.9		SL		22 OZ/A		PRE	A					
		HERB MON 51817	394		SL		20 OZ/A		PRE	A					
		HERB INTACT			L		0.5 % V/V		PRE	A					
12	HERB	VALOR EZ	4	LB/GAL	SC		2 OZ/A		PRE	A	112	208	302	411	
		HERB XTENDIMAX	2.9		SL		22 OZ/A		PRE	A					
		HERB MON 51817	394		SL		20 OZ/A		PRE	A					
13	HERB	AUTHORITY MTZ	45		DF		10 OZ/A		PRE	A	113	210	301	406	
		HERB XTENDIMAX	2.9		SL		22 OZ/A		PRE	A					
		HERB MON 51817	394		SL		20 OZ/A		PRE	A					

Sort Order: Replicate 1

University of Kentucky

Acuron GT: Evaluation of weed control, crop tolerance and yield in a two pass system - Mid and South University

Trial ID: USNG0H5002021 Location: Cully Scott FS Trial Year: 2021
 Protocol ID: HBI008A4-2021US Investigator (Creator): Scott Cully PLANTED 5/13/21 32000 S/A DKC
 Master Protocol ID: Study Director: 65-95
 Official Trial ID: Sponsor Contact:
 Conducted Under GEP: No Trial Origin: P public institution trial PRE: 5/15/21 V2: 6/10

Trt No.	Treatment Name	Form Conc	Form Unit	Form Type	Rate Rate Unit	Other Rate	Other Rate Unit	Appl Timing	Appl Code	Rep 1	Rep 2	Rep 3	Rep 4	Notes
1	CHK UNTREATED CHECK									101	205	311	407	
2	HERB BICEP II MAGNUM	660 gA/L		SC	2470 g Al/ha	1.6 QT/A		PRE	A	102	211	310	411	
	ADJ AMSOL			SL	5.85 L/ha	2.5 QT/A		V2	B					
	ADJ NIS			SL	0.25 % V/V	0.25 % V/V		V2	B					
	HERB ACURON GT	514.35 gA/L		ZC	2260 g Al/ha	3.75 PT/A		V2	B					
3	HERB LEXAR EZ 3.7 ZC	443.8 gA/L		ZC	1870 g Al/ha	1.8 QT/A		PRE	A	103	207	303	408	
	ADJ AMSOL			SL	5.85 L/ha	2.5 QT/A		V2	B					
	ADJ NIS			SL	0.25 % V/V	0.25 % V/V		V2	B					
	HERB ACURON GT	514.35 gA/L		ZC	2260 g Al/ha	3.75 PT/A		V2	B					
4	HERB SURESTART II 4.25 SC	509.26 gA/L		SC	1040 g Al/ha	1.75 PT/A		PRE	A	104	210	306	405	
	ADJ AMSOL			SL	5.85 L/ha	2.5 QT/A		V2	B					
	ADJ NIS			SL	0.25 % V/V	0.25 % V/V		V2	B					
	HERB ACURON GT	514.35 gA/L		ZC	2260 g Al/ha	3.75 PT/A		V2	B					
5	HERB HARNESS XTRA 5.6L	672 gA/L		SC	2830 g Al/ha	1.8 QT/A		PRE	A	105	209	307	409	
	ADJ AMSOL			SL	5.85 L/ha	2.5 QT/A		V2	B					
	ADJ NIS			SL	0.25 % V/V	0.25 % V/V		V2	B					
	HERB ACURON GT	514.35 gA/L		ZC	2260 g Al/ha	3.75 PT/A		V2	B					
6	HERB VERDICT 5.57 EC	667 gA/L		EC	682 g Al/ha	14 FL OZ/A		PRE	A	106	212	305	404	
	ADJ AMSOL			SL	5.85 L/ha	2.5 QT/A		V2	B					
	ADJ NIS			SL	0.25 % V/V	0.25 % V/V		V2	B					
	HERB ACURON GT	514.35 gA/L		ZC	2260 g Al/ha	3.75 PT/A		V2	B					
7	HERB SURESTART II 4.25 SC	509.26 gA/L		SC	1040 g Al/ha	1.75 PT/A		PRE	A	107	202	308	401	
	ADJ AMSOL			SL	5.85 L/ha	2.5 QT/A		V2	B					
	HERB RESICORE 3.29 SC	394.4 gA/L		SC	1150 g Al/ha	1.25 QT/A		V2	B					
	HERB ROUNDUP POWERMAX 4.5 SL	540 gAE/L		SL	1050 g AE/ha	26.6 FL OZ/A		V2	B					
8	HERB HARNESS XTRA 5.6L	672 gA/L		SC	2830 g Al/ha	1.8 QT/A		PRE	A	108	201	312	402	
	ADJ AMSOL			SL	5.85 L/ha	2.5 QT/A		V2	B					
	HERB LAUDIS 3.5 SC	420 gA/L		SC	92.1 g Al/ha	3 FL OZ/A		V2	B					
	HERB ROUNDUP POWERMAX 4.5 SL	540 gAE/L		SL	1050 g AE/ha	26.6 FL OZ/A		V2	B					
	ADJ SUPERB HC			SL	0.5 % V/V	0.5 % V/V		V2	B					
9	HERB VERDICT 5.57 EC	667 gA/L		EC	487 g Al/ha	10 FL OZ/A		PRE	A	109	208	309	406	
	ADJ AMSOL			SL	5.85 L/ha	2.5 QT/A		V2	B					
	HERB ARMEZON PRO	642.5 gA/L		EC	845 g Al/ha	18 FL OZ/A		V2	B					
	HERB ROUNDUP POWERMAX 4.5 SL	540 gAE/L		SL	1050 g AE/ha	26.6 FL OZ/A		V2	B					
10	HERB ACURON XR	424.57 gA/L		ZC	3470 g Al/ha	3.5 QT/A		PRE	A	110	203	304	410	
11	HERB ACURON XR	424.57 gA/L		ZC	2980 g Al/ha	3 QT/A		PRE	A	111	206	301	403	
12	HERB HARNESS MAX 3.85 SC	462 gA/L		SC	2530 g Al/ha	75 FL OZ/A		PRE	A	112	204	302	412	

Sort Order: Replicate 1

University of Kentucky

A23372A: Crop Tolerance and Efficacy in No-Till Soybean (University)

Trial ID: USNG0H5012021 Location: Cully Scott FS Trial Year: 2021
 Protocol ID: HSM051A4-2021US Investigator (Creator): Scott Cully PLANTED 5/13/21 AG 35XF1 150000 S/A
 Master Protocol ID: Study Director: Sara Carter
 Official Trial ID: Sponsor Contact: PRE: 5/14/21
 Conducted Under GEP: No Trial Origin: P public institution trial

Trt No.	Treatment Type Name	Form Conc	Form Unit	Form Type	Rate Rate Unit	Other Rate	Other Rate Unit	Appl Unit	Appl Timing	Rep Code	1	2	3	Notes
1	CHK CHECK										101	211	302	
2	ADJ NIS			SL	0.25 % V/V	0.25 % V/V			PRE	A	102	208	305	
	HERB A23372 [A]	495.7 gA/L		ZC	2430 g AI/ha	4.2 PT/A			PRE	A				
	HERB GRAMOXONE SL 3.0	360 gA/L		SL	842 g AI/ha	2 PT/A			PRE	A				
3	ADJ AMSOL			SL	2.5 % V/V	2.5 % V/V			PRE	A	103	210	311	
	HERB A23372 [A]	495.7 gA/L		ZC	2430 g AI/ha	4.2 PT/A			PRE	A				
	HERB ROUNDUP POWERMAX 4.5 SL	540 gAE/L		SL	1260 g AE/ha	2 PT/A			PRE	A				
4	ADJ VOLT-EDGE			L	1.46 L/ha	20 FL OZ/A			PRE	A	104	209	301	
	ADJ INTACT			SL	0.5 % V/V	0.5 % V/V			PRE	A				
	ADJ CLASS ACT RIDION			SL	1 % V/V	1 % V/V			PRE	A				
	HERB A23372 [A]	495.7 gA/L		ZC	2430 g AI/ha	4.2 PT/A			PRE	A				
	HERB XTENDIMAX 2.9 SL	350.2 gAE/L		SL	563 g AE/ha	22 FL OZ/A			PRE	A				
	HERB ROUNDUP POWERMAX 4.5 SL	540 gAE/L		SL	1260 g AE/ha	2 PT/A			PRE	A				
5	ADJ NIS			SL	0.25 % V/V	0.25 % V/V			PRE	A	105	203	310	
	HERB BOUNDARY 6.5 EC	777.5 gA/L		EC	1820 g AI/ha	2 PT/A			PRE	A				
	HERB GRAMOXONE SL 3.0	360 gA/L		SL	842 g AI/ha	2 PT/A			PRE	A				
6	ADJ AMSOL			SL	2.5 % V/V	2.5 % V/V			PRE	A	106	202	303	
	HERB BOUNDARY 6.5 EC	777.5 gA/L		EC	1820 g AI/ha	2 PT/A			PRE	A				
	HERB ROUNDUP POWERMAX 4.5 SL	540 gAE/L		SL	1260 g AE/ha	2 PT/A			PRE	A				
7	ADJ VOLT-EDGE			L	1.46 L/ha	20 FL OZ/A			PRE	A	107	204	306	
	ADJ INTACT			SL	0.5 % V/V	0.5 % V/V			PRE	A				
	ADJ CLASS ACT RIDION			SL	1 % V/V	1 % V/V			PRE	A				
	HERB BOUNDARY 6.5 EC	777.5 gA/L		EC	1820 g AI/ha	2 PT/A			PRE	A				
	HERB XTENDIMAX 2.9 SL	350.2 gAE/L		SL	563 g AE/ha	22 FL OZ/A			PRE	A				
	HERB ROUNDUP POWERMAX 4.5 SL	540 gAE/L		SL	1260 g AE/ha	2 PT/A			PRE	A				
8	ADJ AMSOL			SL	2.5 % V/V	2.5 % V/V			PRE	A	108	206	312	
	ADJ PREMIUM MSO			SL	1 % V/V	1 % V/V			PRE	A				
	HERB ZIDUA PRO 4.09 SC	490.09 gA/L		SC	161 g AI/ha	4.5 FL OZ/A			PRE	A				
	HERB GRAMOXONE SL 3.0	360 gA/L		SL	842 g AI/ha	2 PT/A			PRE	A				
9	ADJ AMSOL			SL	2.5 % V/V	2.5 % V/V			PRE	A	109	201	309	
	HERB ZIDUA PRO 4.09 SC	490.09 gA/L		SC	161 g AI/ha	4.5 FL OZ/A			PRE	A				
	HERB ROUNDUP POWERMAX 4.5 SL	540 gAE/L		SL	1260 g AE/ha	2 PT/A			PRE	A				
	ADJ PREMIUM MSO			SL	1 % V/V	1 % V/V			PRE	A				
10	ADJ VOLT-EDGE			L	1.46 L/ha	20 FL OZ/A			PRE	A	110	207	304	
	ADJ INTACT			SL	0.5 % V/V	0.5 % V/V			PRE	A				
	ADJ CLASS ACT RIDION			SL	1 % V/V	1 % V/V			PRE	A				
	HERB ZIDUA PRO 4.09 SC	490.09 gA/L		SC	161 g AI/ha	4.5 FL OZ/A			PRE	A				
	HERB XTENDIMAX 2.9 SL	350.2 gAE/L		SL	563 g AE/ha	22 FL OZ/A			PRE	A				
	HERB ROUNDUP POWERMAX 4.5 SL	540 gAE/L		SL	1260 g AE/ha	2 PT/A			PRE	A				
	ADJ PREMIUM MSO			SL	1 % V/V	1 % V/V			PRE	A				
11	ADJ VOLT-EDGE			L	1.46 L/ha	20 FL OZ/A			PRE	A	111	212	308	
	ADJ INTACT			SL	0.5 % V/V	0.5 % V/V			PRE	A				
	ADJ CLASS ACT RIDION			SL	1 % V/V	1 % V/V			PRE	A				
	HERB PREFIX [F]	631.68 gA/L		EC	1480 g AI/ha	2 PT/A			PRE	A				
	HERB XTENDIMAX 2.9 SL	350.2 gAE/L		SL	563 g AE/ha	22 FL OZ/A			PRE	A				
	HERB ROUNDUP POWERMAX 4.5 SL	540 gAE/L		SL	1260 g AE/ha	2 PT/A			PRE	A				
12	ADJ VOLT-EDGE			L	1.46 L/ha	20 FL OZ/A			PRE	A	112	205	307	
	ADJ INTACT			SL	0.5 % V/V	0.5 % V/V			PRE	A				
	ADJ CLASS ACT RIDION			SL	1 % V/V	1 % V/V			PRE	A				
	HERB TAVIUM PLUS VAPORGRIP TECH	406.8 gAE/L		CS	1680 g AI/ha	56.5 FL OZ/A			PRE	A				
	HERB ROUNDUP POWERMAX 4.5 SL	540 gAE/L		SL	1260 g AE/ha	2 PT/A			PRE	A				

Sort Order: Replicate 1

University of Kentucky

Enlist E3 Soybean Programs

Trial ID: 21-34_SOY-LEX Location: Trial Year: 2021 PLANTED 6/7/21
 Protocol ID: Enlist Soybean Programs Investigator (Creator): Sara Carter
 Project ID: Study Director:
 Sponsor Contact: PRE: 6/7 4"W

Trt No.	Treatment Name	Form Conc	Form Unit	Form Type	Rate	Rate Unit	Appl Timing	Appl Code	Rep 1	Rep 2	Rep 3	Rep 4	Notes
1	CHK Untreated								101	206	302	401	
2	HERB Broadaxe XC	7 LBA/GAL	L	L	22 FL OZ/A	PRE	A		102	205	304	405	
	HERB Dimetric Liquid	3 LBA/GAL	L	L	10.5 FL OZ/A	PRE	A						
	HERB Prefix	5.29 LB/GAL	L	L	2.33 PT/A	POST	B						
	HERB Enlist One	3.8 lbae/gal	SL	SL	32 FL OZ/A	POST	B						
	HERB Roundup PowerMAX 3	4.8 LBAE/GAL	SL	SL	30 FL OZ/A	POST	B						
	ADJ AMS - Liquid	3.4 lba/gal	SL	SL	2.5 % V/V	POST	B						
3	HERB Boundary	6.5 LBA/GAL	EC	EC	1.5 PT/A	PRE	A		103	208	305	402	
	HERB Prefix	5.29 LB/GAL	L	L	2.33 PT/A	POST	B						
	HERB Enlist One	3.8 lbae/gal	SL	SL	32 FL OZ/A	POST	B						
	HERB Roundup PowerMAX 3	4.8 LBAE/GAL	SL	SL	30 FL OZ/A	POST	B						
	ADJ AMS - Liquid	3.4 lba/gal	SL	SL	2.5 % V/V	POST	B						
4	HERB Prefix	5.29 LB/GAL	L	L	2.33 PT/A	PRE	A		104	201	306	407	
	HERB Dimetric Liquid	3 LBA/GAL	L	L	10.5 FL OZ/A	PRE	A						
	HERB Enlist One	3.8 lbae/gal	SL	SL	32 FL OZ/A	POST	B						
	HERB Roundup PowerMAX 3	4.8 LBAE/GAL	SL	SL	30 FL OZ/A	POST	B						
	ADJ AMS - Liquid	3.4 lba/gal	SL	SL	2.5 % V/V	POST	B						
5	HERB Kyber	2.6 lba/gal	SC	SC	1 PT/A	PRE	A		105	202	308	403	
	HERB Enlist Duo	3.3 lbae/gal	SL	SL	4.75 PT/A	POST	B						
	ADJ AMS - Liquid	3.4 lba/gal	SL	SL	2.5 % V/V	POST	B						
6	HERB Trivence	61.3 %	WG	WG	8 OZ/A	PRE	A		106	204	301	408	
	HERB EverpreX	7.62 LBA/GAL	EC	EC	1 PT/A	POST	B						
	HERB Enlist Duo	3.3 lbae/gal	SL	SL	4.75 PT/A	POST	B						
	ADJ AMS - Liquid	3.4 lba/gal	SL	SL	2.5 % V/V	POST	B						
7	HERB Zidua Pro	4.09 LBA/GAL	SC	SC	6 FL OZ/A	PRE	A		107	203	307	406	
	HERB Enlist Duo	3.3 lbae/gal	SL	SL	4.75 PT/A	POST	B						
	ADJ AMS - Liquid	3.4 lba/gal	SL	SL	2.5 % V/V	POST	B						
8	HERB Authority XL	70 %	DF	DF	6.5 OZ/A	PRE	A		108	207	303	404	
	HERB Enlist Duo	3.3 lbae/gal	SL	SL	4.75 PT/A	POST	B						
	ADJ AMS - Liquid	3.4 lba/gal	SL	SL	2.5 % V/V	POST	B						

Sort Order: Replicate 1

University of Kentucky

RR2Xtend Soybean Programs

Trial ID: 21-35_SOY-LEX
 Protocol ID: RR2Xtend Soybean Programs
 Project ID:
 Location: UKREC 201-D
 Investigator (Creator): Sara Carter
 Study Director:
 Sponsor Contact:

PLANTED6/7/21

PRE 6/10 4"W:

Trt No.	Treatment Type Name	Form Conc	Form Unit	Form Type	Rate Rate Unit	Appl Timing	Appl Code	Rep 1	Rep 2	Rep 3	Rep 4	Notes
1	CHK Untreated							101	203	305	401	
2	HERB Broadaxe XC	7	LBA/GAL	L	22	FL OZ/A	PRE	A	102	206	303	404
	HERB Dimetric Liquid	3	LBA/GAL	L	10.5	FL OZ/A	PRE	A				
	HERB Prefix	5.29	LB/GAL	L	2.33	PT/A	POST	B				
	HERB XTENDIMAX WITH VAPORGRIP	2.9	lbae/gal	SL	22	FL OZ/A	POST	B				
	HERB Roundup PowerMAX 3	4.8	LBAE/GAL	SL	30	FL OZ/A	POST	B				
	ADJ INTACT	100	%	SL	0.5	% V/V	POST	B				
	ADJ VaporGrip Xtra Agent	100	%	SL	20	FL OZ/A	POST	B				
3	HERB Boundary	6.5	LBA/GAL	EC	1.5	PT/A	PRE	A	103	204	302	406
	HERB Prefix	5.29	LB/GAL	L	2.33	PT/A	POST	B				
	HERB XTENDIMAX WITH VAPORGRIP	2.9	lbae/gal	SL	22	FL OZ/A	POST	B				
	HERB Roundup PowerMAX 3	4.8	LBAE/GAL	SL	30	FL OZ/A	POST	B				
	ADJ INTACT	100	%	SL	0.5	% V/V	POST	B				
	ADJ VaporGrip Xtra Agent	100	%	SL	20	FL OZ/A	POST	B				
4	HERB Prefix	5.29	LB/GAL	L	2.33	PT/A	PRE	A	104	202	306	402
	HERB Dimetric Liquid	3	LBA/GAL	L	10.5	FL OZ/A	PRE	A				
	HERB Tavium	3.38	LBA/GAL	CS	56.5	FL OZ/A	POST	B				
	HERB Roundup PowerMAX 3	4.8	LBAE/GAL	SL	30	FL OZ/A	POST	B				
	ADJ INTACT	100	%	SL	0.5	% V/V	POST	B				
	ADJ VaporGrip Xtra Agent	100	%	SL	20	FL OZ/A	POST	B				
5	HERB Fierce EZ	3.04	LBA/GAL	SC	6	FL OZ/A	PRE	A	105	201	304	405
	HERB Roundup PowerMAX 3	4.8	LBAE/GAL	SL	30	FL OZ/A	POST	B				
	HERB XTENDIMAX WITH VAPORGRIP	2.9	lbae/gal	SL	22	FL OZ/A	POST	B				
	HERB Perpetuo	2.3	lba/gal	SC	6	FL OZ/A	POST	B				
	ADJ INTACT	100	%	SL	0.5	% V/V	POST	B				
	ADJ VaporGrip Xtra Agent	100	%	SL	20	FL OZ/A	POST	B				
6	HERB Fierce MTZ	2.64	LBA/GAL	SC	1	PT/A	PRE	A	106	205	301	403
	HERB Roundup PowerMAX 3	4.8	LBAE/GAL	SL	30	FL OZ/A	POST	B				
	HERB XTENDIMAX WITH VAPORGRIP	2.9	lbae/gal	SL	22	FL OZ/A	POST	B				
	HERB Perpetuo	2.3	lba/gal	SC	6	FL OZ/A	POST	B				
	ADJ INTACT	100	%	SL	0.5	% V/V	POST	B				
	ADJ VaporGrip Xtra Agent	100	%	SL	20	FL OZ/A	POST	B				

Sort Order: Replicate 1

University of Kentucky

VALENT AND SYNGENTA CORN

Trial Year: 2021

Trial ID: 21-36 Location:
Protocol ID: 21-36 Investigator (Creator): Sara Carter
Project ID: Study Director:
Sponsor Contact:

PLANTED 5/13 DKC 65-95 32000 S/A

PRE: 5/15 V2:: 6/10 42DAP:

Trt No.	Treatment Type Name	Form Conc	Form Unit	Form Type	Rate Rate Unit	Appl Timing	Appl Code	Rep 1	Rep 2	Rep 3	Rep 4	Notes
1	HERB V-10494	2.04	LBA/GAL	SC	1 QT/A	PRE	A	101	206	303	405	
	HERB ROUNDUP POWERMAX	4.5		SL	1 QT/A	42DAP	C					
	HERB INDUCE			SL	0.25 % V/V	42DAP	C					
	HERB AMS	100		SG	3 LB/A	42DAP	C					
2	HERB V-10494	2.04	LB/GAL	SC	1 QT/A	PRE	A	102	204	302	404	
	HERB ATRAZINE	4		L	0.75 LB AI/A	PRE	A					
	HERB ROUNDUP POWERMAX	4.5		SL	1 QT/A	42DAP	C					
	HERB INDUCE			SL	0.25 % V/V	42DAP	C					
	HERB AMS	100		SG	3 LB/A	42DAP	C					
3	HERB LEXAR EZ	3.7		ZC	1.8 QT/A	PRE	A	103	202	306	401	
	HERB ACURON GT	514.35	gA/L	ZC	3.75 PT/A	V2	B					
	HERB AATREX	4		F	1 PT/A	V2	B					
	HERB NIS			L	0.25 % V/V	V2	B					
	HERB AMS			L	2.5 % V/V	V2	B					
4	HERB BICEP II MAGNUM	5.5		L	1.6 QT/A	PRE	A	104	205	304	403	
	HERB ACURON GT	514.35	gA/L	ZC	3.75 PT/A	V2	B					
	HERB AATREX	4		F	1 PT/A	V2	B					
	HERB NIS			L	0.25 % V/V	V2	B					
	HERB AMS			L	2.5 % V/V	V2	B					
5	HERB VERDICT	2		EC	10 OZ/A	PRE	A	105	201	305	406	
	HERB ARMEZON PRO	6.25		L	18 OZ/A	V2	B					
	HERB ROUNDUP POWERMAX	4.5		SL	22 OZ/A	V2	B					
6	HERB SURESTART	4.18		SE	1.75 PT/A	PRE	A	106	203	301	402	
	HERB RESICORE	3.3		SC	1.25 QT/A	V2	B					
	HERB ROUNDUP POWERMAX	4.5		SL	22 OZ/A	V2	B					

Sort Order: Replicate 1

University of Kentucky

VALENT SOY RR2X NT YIELD

Trial ID: 21-37 Location:
 Protocol ID: 21-37 Investigator (Creator): Sara Carter
 Project ID: Study Director: Sara Carter
 Sponsor Contact:

Trial Year: 2021

PLANTED 5/13 AG35XF1 150000 S/A

PRE: 5/14 4"W: 6/22

Trt No.	Treatment Name	Form Conc	Form Unit	Form Type	Rate	Rate Unit	Appl Timing	Appl Code	Rep 1	Rep 2	Rep 3	Rep 4	Notes
1	HERB CHECK UNTREATED								101	203	301	403	
2	HERB ROUNDUP POWERMAX	4.5		SL	32 FL OZ/A	PRE	A		102	204	305	404	
	HERB XTENDIMAX	2.9		SL	22 FL OZ/A	PRE	A						
	HERB FIERCE EZ	3.04	LBA/GAL	SC	6 FL OZ/A	PRE	A						
	HERB INDUCE			SL	0.25 % V/V	PRE	A						
	HERB DRIFT X	100	%W/W	AJ	0.5 % V/V	PRE	A						
	HERB ROUNDUP POWERMAX	4.5		SL	32 FL OZ/A	4"W	B						
	HERB XTENDIMAX	2.9		SL	22 FL OZ/A	4"W	B						
	HERB PERPETUO	2.3	LB/GAL	SC	6 FL OZ/A	4"W	B						
	HERB SELECT MAX	0.97		EC	9 FL OZ/A	4"W	B						
	HERB DRIFT X	100	%W/W	AJ	0.5 % V/V	4"W	B						
	HERB INDUCE			SL	0.25 % V/V	4"W	B						
3	HERB ROUNDUP POWERMAX	4.5		SL	32 FL OZ/A	PRE	A		103	205	302	401	
	HERB XTENDIMAX	2.9		SL	22 FL OZ/A	PRE	A						
	HERB FIERCE MTZ	2.64	LB/GAL	SC	1 PT/A	PRE	A						
	HERB INDUCE			SL	0.25 % V/V	PRE	A						
	HERB DRIFT X	100	%W/W	AJ	0.5 % V/V	PRE	A						
	HERB ROUNDUP POWERMAX	4.5		SL	32 FL OZ/A	4"W	B						
	HERB XTENDIMAX	2.9		SL	22 FL OZ/A	4"W	B						
	HERB PERPETUO	2.3	LB/GAL	SC	6 FL OZ/A	4"W	B						
	HERB SELECT MAX	0.97		EC	9 FL OZ/A	4"W	B						
	HERB DRIFT X	100	%W/W	AJ	0.5 % V/V	4"W	B						
	HERB INDUCE			SL	0.25 % V/V	4"W	B						
4	HERB ROUNDUP POWERMAX	4.5		SL	32 FL OZ/A	PRE	A		104	201	306	402	
	HERB XTENDIMAX	2.9		SL	22 FL OZ/A	PRE	A						
	HERB VALOR XLT	40.3		WG	4 OZ/A	PRE	A						
	HERB INDUCE			SL	0.25 % V/V	PRE	A						
	HERB DRIFT X	100	%W/W	AJ	0.5 % V/V	PRE	A						
	HERB ROUNDUP POWERMAX	4.5		SL	32 FL OZ/A	4"W	B						
	HERB XTENDIMAX	2.9		SL	22 FL OZ/A	4"W	B						
	HERB PERPETUO	2.3	LB/GAL	SC	6 FL OZ/A	4"W	B						
	HERB SELECT MAX	0.97		EC	9 FL OZ/A	4"W	B						
	HERB DRIFT X	100	%W/W	AJ	0.5 % V/V	4"W	B						
	HERB INDUCE			SL	0.25 % V/V	4"W	B						
5	HERB ROUNDUP POWERMAX	4.5		SL	32 FL OZ/A	PRE	A		105	206	303	405	
	HERB XTENDIMAX	2.9		SL	22 FL OZ/A	PRE	A						
	HERB CANOPY	75		DF	4 OZ/A	PRE	A						
	HERB INDUCE			SL	0.25 % V/V	PRE	A						
	HERB DRIFT X	100	%W/W	AJ	0.5 % V/V	PRE	A						
	HERB ROUNDUP POWERMAX	4.5		SL	32 FL OZ/A	4"W	B						
	HERB XTENDIMAX	2.9		SL	22 FL OZ/A	4"W	B						
	HERB PERPETUO	2.3	LB/GAL	SC	6 FL OZ/A	4"W	B						
	HERB SELECT MAX	0.97		EC	9 FL OZ/A	4"W	B						
	HERB DRIFT X	100	%W/W	AJ	0.5 % V/V	4"W	B						
	HERB INDUCE			SL	0.25 % V/V	4"W	B						
6	HERB ROUNDUP POWERMAX	4.5		SL	32 FL OZ/A	PRE	A		106	202	304	406	
	HERB XTENDIMAX	2.9		SL	22 FL OZ/A	PRE	A						
	HERB AUTHORITY FIRST	70		DF	6.45 OZ/A	PRE	A						
	HERB INDUCE			SL	0.25 % V/V	PRE	A						
	HERB DRIFT X	100	%W/W	AJ	0.5 % V/V	PRE	A						
	HERB ROUNDUP POWERMAX	4.5		SL	32 FL OZ/A	4"W	B						
	HERB XTENDIMAX	2.9		SL	22 FL OZ/A	4"W	B						
	HERB PERPETUO	2.3	LB/GAL	SC	6 FL OZ/A	4"W	B						
	HERB SELECT MAX	0.97		EC	9 FL OZ/A	4"W	B						
	HERB DRIFT X	100	%W/W	AJ	0.5 % V/V	4"W	B						
	HERB INDUCE			SL	0.25 % V/V	4"W	B						

Sort Order: Replicate 1

University of Kentucky

VALENT SOYBEAN LL YIELD

Trial ID: 21-38 Location:
 Protocol ID: 21-38 Investigator (Creator): Sara Carter
 Project ID: Study Director: Sara Carter
 Sponsor Contact:

Trial Year: 2021

PLANTED 5/13 CZ4701GTLL 150000 S/A

PRE: 5/14 2"W: 6/17

Trt No.	Type	Treatment Name	Form Conc	Form Unit	Form Type	Rate	Rate Unit	Appl Timing	Appl Code	Rep 1	Rep 2	Rep 3	Rep 4	Notes
1		HERB CHECK UNTREATED								101	206	302	403	
2		HERB FIERCE EZ	3.04	LBA/GAL	SC	6	FL OZ/A	PRE	A	102	204	303	406	
		HERB SCOUT	2.34	LB/GAL	SL	32	FL OZ/A	2"W	B					
		HERB PERPETUO	2.3	LB/GAL	SC	6	FL OZ/A	2"W	B					
		HERB AMS	100		SG	3	LB/A	2"W	B					
3		HERB FIERCE MTZ	2.64	LB/GAL	SC	16	FL OZ/A	PRE	A	103	205	304	402	
		HERB SCOUT	2.34	LB/GAL	SL	32	FL OZ/A	2"W	B					
		HERB PERPETUO	2.3	LB/GAL	SC	6	FL OZ/A	2"W	B					
		HERB AMS	100		SG	3	LB/A	2"W	B					
4		HERB AUTHORITY MTZ	45		DF	11	OZ WT/A	PRE	A	104	203	306	405	
		HERB SCOUT	2.34	LB/GAL	SL	32	FL OZ/A	2"W	B					
		HERB ANTHEM MAXX	4.3		SE	2.5	FL OZ/A	2"W	B					
		HERB AMS	100		SG	3	LB/A	2"W	B					
5		HERB MOCCASIN MTZ	4.5	LB/GAL	EC	40	FL OZ/A	PRE	A	105	202	301	404	
		HERB SCEPTER	70		DG	2.1	OZ WT/A	PRE	A					
		HERB INTERLINE	2.34		SC	32	FL OZ/A	2"W	B					
		HERB AMS			L	2.5	% V/V	2"W	B					
6		HERB TRIPZIN ZC	4	LB/GAL	ZC	42	FL OZ/A	PRE	A	106	201	305	401	
		HERB SCEPTER	70		DG	2.1	OZ WT/A	PRE	A					
		HERB INTERLINE	2.34		SC	32	FL OZ/A	2"W	B					
		HERB AMS			L	2.5	% V/V	2"W	B					

Sort Order: Replicate 1

Trial: CE2
Year: 2021

TRIAL YEAR CE2 2020-21 TRTS AND SUBPLOT ORDER FIXED



treatment list

- 1 no cover
- 2 early termination
- 3 late termination
- 4 middle termination

- PRE on corn (2021)
- no PRE on corn (2021)

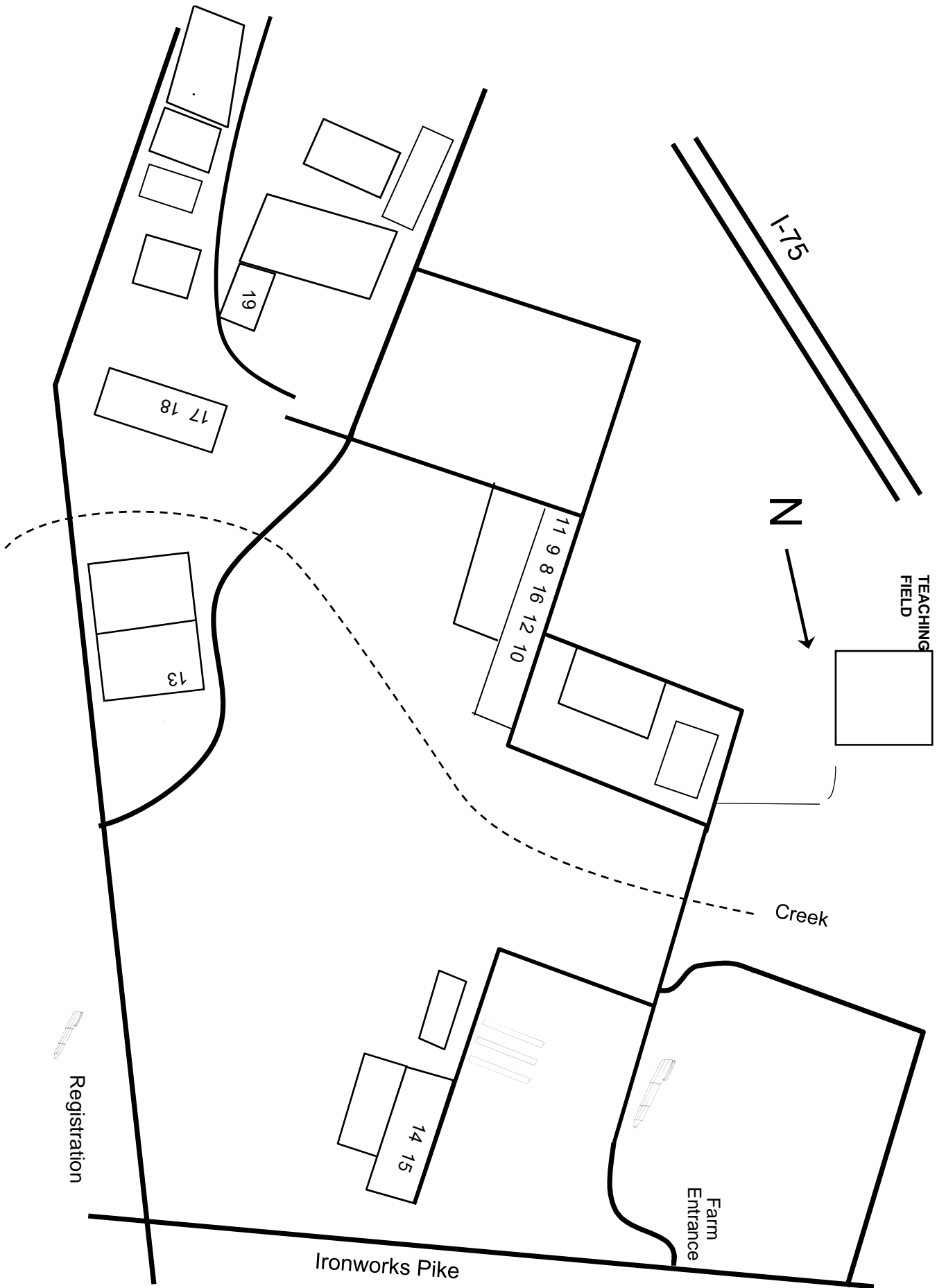

Location of Study by Page Number